

Eden District Council

Finance Scrutiny

10 January 2023

Inspiring Eden Project

Portfolio:	Economy and Enterprise
Report from:	Assistant Director Development
Wards:	All Wards
OPEN PUBLIC ITEM	

1 Purpose

- 1.1 Finance Scrutiny Committee have asked to scrutinise Inspiring Eden, the council's plan for economic recovery, prosperity and levelling up.

2 Recommendation

- 2.1 It is recommended that the Committee review the Inspiring Eden Update Report provided to Cabinet for their meeting on 15 November and raise any questions they have for consideration and response.

3 Report Details

Background

- 3.1 On 15 November, Cabinet considered an update report on Inspiring Eden, this is attached at Appendix 1.
- 3.2 The Inspiring Eden Programme seeks drive economic recovery, prosperity and levelling up across the district. It aims to do this via an Economic Prospectus supported by 14 workstreams (including Business Support; Sector Plan Rural Economy; Town Centre Plans; A66 Dualling). The Economic Prospectus and supporting workstreams are focused around the overarching vision of achieving rural excellence and will drive delivery via a number of funding streams.

Funding Stream Opportunities

- 3.3 As part of the funding of Corporate Priorities in 22/23, the council approved a budget of £780k for the Economic Development Framework in 22/23 through the approval of the Quarter 2 Monitoring, Revised Budget and MTFP approved by Council on 25 November 2021.
- 3.4 EDC has an opportunity to draw down it's share of the UK Shared Prosperity Fund of £1,990,203 for the 2022 to 2025 through the approval by Government of an investment plan which was submitted on 1 August 2022. This has since been approved by Government unlocking the funding of £241,529 (plus £20k Capacity Funding) for the current financial year subject to the signing and submission of a Memorandum of Understanding by 16 December 2022.
- 3.5 In addition, EDC has the opportunity to draw down a UKSPF Rural top up fund of **£1,051,689**. A rural addendum has been submitted to Government for

consideration which should be approved in early 2023 for spend from April 2023 to March 2025. This is detailed in the Cabinet report in Appendix 1.

- 3.6 EDC submitted a bid for round 2 of Levelling Up Fund by 1 August 2022 for the Inspiring Eden Enterprise Hub project the outcome of which should be announced by Government in early 2023.
- 3.7 Through the Borderlands Inclusive Growth Deal, £50m has been committed by UK and Scottish Governments to the Borderlands Place Programme. This will target investment in places that will help boost economic activity across the region and recognises the importance smaller rural market towns – like Penrith – play in the local economy. EDC are working with a range of local and strategic partners to develop projects for inclusion as part of the Penrith Borderland's Investment Plan to draw down funding from the Growth Deal through 2023 for spend up to 2027.

Current Strengths/Opportunities of Inspiring Eden

- 3.8 EDC is currently developing a comprehensive pipeline / programme of projects to put Eden in a strong position going into Westmorland and Furness Council.
- 3.9 The bringing together of projects under the umbrella of Inspiring Eden Programme has created a strong policy position which is gaining momentum.
- 3.10 There is a strong emerging pipeline and interest from local and strategic partners demonstrated via Inspiring Eden's Expression of Interest process where we have received 126 expressions of interest so far.

Current Challenges of Inspiring Eden

- 3.11 The capability and capacity within EDC to secure funding and develop and run projects (against ambition) within the timeframes of LGR is restricted due to the resources levels especially on the project delivery side. This has been bolstered in recent month with the appoint of 1.6 FTE project managers.
- 3.12 The Programme works across a very complex landscape, especially working jointly with LGR partners.
- 3.13 Potential loss/lack of focus on economic development agenda post LGR. This is currently being addressed through joint working groups to ensure a smooth transition.

4 Policy Framework

- 4.1 The Council has four corporate priorities which are:
 - Sustainable;
 - Healthy, safe and secure;
 - Connected; and
 - Creative
- 4.2 The Inspiring Eden report itself will meet all four corporate priorities, however the purpose of this report is to scrutinize the financial elements and hence meets the sustainable corporate priority.

5 Consultation

- 5.1 The Portfolio Holder for Economy and Enterprise have been consulted on the report to Cabinet and Cabinet have received regular updates on the Inspiring Eden Programme.

6 Implications

6.1 Financial and Resources

- 6.1.1 Any decision to reduce or increase resources or alternatively increase income must be made within the context of the Council's stated priorities, as set out in its Council Plan 2019-2023 as agreed at Council on 7 November 2019.
- 6.1.2 The financial implications of the Inspiring Eden Programme are dealt with in the Cabinet report in Appendix 1. The project will be funded from a one-off corporate priority allocation of revenue budgets in 2022/23 and then by grant funding from a variety of external sources including the UKSPF. Staffing of the project from 2023/24 onwards will need to be financed from a combination of existing budgets and administration fees from the grants received to reflect that staffing will be provided via a combination of core economic development staff and consultants.
- 6.1.3 The nature of this report is to provide scrutiny on the financial matters of the Inspiring Eden Programme.

6.2 Legal

- 6.2.1 There are no Legal implications of this scrutiny report.

6.3 Human Resources

- 6.3.1 There are no human resource implications to this scrutiny report.

6.4 Environmental

- 6.4.1 There are no environmental implications to this scrutiny report.

6.5 Statutory Considerations

Consideration:	Details of any implications and proposed measures to address:
Equality and Diversity	No implications
Health, Social Environmental and Economic Impact	No implications
Crime and Disorder	No implications
Children and Safeguarding	No implications

6.6 Risk Management

Risk	Consequence	Controls Required
Risk that the opportunities available to EDC are not	EDC are not successful in receiving funding.	The Inspiring Eden programme has sufficient resource to

Risk	Consequence	Controls Required
maximised.		bid/apply for the funds available. Cabinet received regular reports on the progress of the programme.
Risk that the funding available to EDC is not utilised in the best manner for the community.	The funding is allocated to projects that do not maximise the benefit to the community.	Members approve the allocation of funds received to projects meeting criteria that maximise the likely benefit to the community.

7 Other Options Considered

7.1 No other options were considered.

8 Reasons for the Decision/Recommendation

8.1 To ensure financial scrutiny of the Inspiring Eden Programme.

Tracking Information

Governance Check	Date Considered
Chief Finance Officer (or Deputy)	N/A
Monitoring Officer (or Deputy)	N/A
Deputy Chief Executive	16 December 2022
Relevant Assistant Director	14 December 2022

Background Papers: None

Appendices: Inspiring Eden – Update Report to Cabinet on 15 November 2022

Contact Officer: Greg Macdonald, Inspiring Eden Programme Lead

Report No: DCE49/22

Eden District Council

Cabinet

15 November 2022

Inspiring Eden – Update

Portfolio:	Economy and Enterprise
Report from:	Assistant Director Development
Wards:	All Wards
OPEN PUBLIC ITEM	

1 Purpose

- 1.1 The purpose of this report is to present, for noting and approval, updates on the:
- Inspiring Eden Delivery Programme
 - Inspiring Eden Enterprise Hub Levelling Up Bid
 - Inspiring Eden UK Shared Prosperity Fund
 - Penrith Borderlands Inclusive Growth Deal
 - Inspiring Eden Investment Zone submission
- 1.2 As well as driving local economic recovery and prosperity Inspiring Eden will ensure Eden District Council is well placed to shape the economic policy focus and associated work streams as part of both the local government reorganisation process across Cumbria.

2 Recommendations

It is recommended that:

1. The position of the Inspiring Eden Delivery Programme, as detailed in Section 3.1 of this report, is noted with authority delegated to the Assistant Director Development, in consultation with the Portfolio Holder for Economy and Enterprise, to continue to drive delivery.
2. The position regarding the Inspiring Eden Enterprise Hub, as detailed in Section 3.2 of this report, is noted with authority delegated to the Assistant Director Development, in consultation with the Portfolio Holder for Economy and Enterprise, to continue to develop the project. This will include undertaking negotiations with the landowner as the basis for producing a draft heads of terms for consideration by Cabinet.
3. The position of the UKSPF, as detailed in Section 3.3 of this report, is noted with authority delegated to the Assistant Director Development, in consultation with the Portfolio Holder for Economy and Enterprise, to agree the allocation of funding for the current financial year.
4. The update on the UK Shared Prosperity Fund Rural Top Up to the investment plans submitted by Eden District Council as detailed in section 3.4 of this report is noted.

5. Authority is delegated to the Assistant Director Development, in consultation with the Portfolio Holder for Economy and Enterprise, to give consent on behalf of Eden District Council to the final UK Shared Prosperity Fund Rural Top Up Addendum to the Eden investment plans and to the submission of those plans to DLUHC by 30 November 2022.
6. The position of the Penrith Borderlands Inclusive Growth Deal, as detailed in Section 3.4 of this report, is noted with authority delegated to the Assistant Director Development, in consultation with the Portfolio Holder for Economy and Enterprise, to continue to work with partners to develop projects for inclusion in a draft Investment Plan.
7. The position of the Inspiring Eden Investment Zone submission, as detailed in Section 3.1.3 (**Sites and Premises** section) of this report, is noted with authority delegated to the Assistant Director Development, in consultation with the Portfolio Holder for Economy and Enterprise, to continue to work with partners to develop the proposal ready for final sign off by Cabinet.

3 Report Details

3.1 Update on Inspiring Eden Delivery Programme

- 3.1.1 To date 126 Inspiring Eden Expressions of Interest (EOI) have been received which are currently feeding into the development of a comprehensive pipeline and programme of projects to:
 - Inform the allocation of the Inspiring Eden Investment fund (see Appendix 1 – Inspiring Eden Pipeline of Projects);
 - Inform the LUF Round 2 Bid – Bid submitted which is focused on the Inspiring Eden Enterprise Hub as detailed in Section 3.2 (see Appendix 2 - Inspiring Eden Enterprise Hub Prospectus);
 - Inform the delivery of the UKSPF Investment plan over the coming weeks and months as detailed in Section 3.3 below;
 - Inform the production of other bids and investment plans including the current Penrith Borderlands Inclusive Growth Deal (see Section 3.4) and the Government Changes Places Programme with a bid submitted to the latter on 30 September.
- 3.1.2 The Inspiring Eden projects are being assessed against strategic fit, value for money and deliverability. A recommendation for each project is made to the Inspiring Eden Programme Board as to proposed next steps which include (not an exhaustive list):
 - Being supported via the Inspiring Eden Investment Fund, the Borderlands Inclusive Growth Deal, UKSPF or a combination of these funds;
 - Signposting to existing programmes to seek support e.g. Greening Eden Business Grants, Inspiring Eden Apprenticeship Grants and Inspiring Eden Welcome back Fund;
 - Provision of project support to develop the project to a position where it is ready for delivery and being considered for funding; and
 - Consideration for new local government arrangements post 1 April 2023.

3.1.3 In addition to the programme of projects detailed in Appendix 1, the key updates on the Inspiring Eden Work Streams are as follows:

- **Business Support** – Business support continues with a range of offers to meet the current and emerging needs of businesses with a particular focus on free memberships for business networks and targeted support for new start businesses. Another successful Inspiring Eden Business Breakfast event was held jointly with the Cumbria Chamber of Commerce on 6 October with a focus on recruitment and connectivity challenges for training and work.
- **Sites and Premises** – A study to assess the viability of developing a strategic employment site around junction 41 of the M6 is in near completion and will be reported to a future meeting. This links to the Inspiring Eden Enterprise Hub which will act as a catalyst and kick start for development in the area. In this context consideration is also being given to the Government's proposals regarding Investment Zones which aim to simplify and accelerate the development process to aid national growth ambitions. The junction 41 site (with initial focus around the Inspiring Eden Enterprise Hub) has been included in the County Council's Investment Zone Expression of Interest submitted to Government on the 14 October. Further details and any required decisions will be presented at a future Cabinet meeting once the outcome of the Expression of Interest is known.
- **Rural Economy** – Work is underway with the Farmers Network to deliver the Inspiring Eden Farmers Support and Advisory Service to provide bespoke and 1-1 assistance to local farmers. Current activity through a range of workshops and 1-1s includes a focus on decarbonisation and farm diversification.
- **Visitor Economy** – The Eden Tourism Network continues to support local visitor economy in addressing issues around recruitment and developing and promoting the local offer. The Visitor Guide for 2023 is currently in production.
- **Skills and Employment** – The Inspiring Eden Apprenticeship scheme continues to be utilised by local business to help develop the local workforce. The Inspiring Eden Youth Hub is going from strength to strength in supporting local vulnerable young people back into training and employment. The project is being extended for another year and plans are being developed to explore extending the range of activities on offer to help local young people into training and work.
- **Town Centres** – Work continues with a range of local partners to develop local initiatives to support the recovery of all of our local town centres. This includes a number of new markets across the district, improvements to buildings including, for example, the Cloisters and Pizza Roma buildings in Appleby and scoping improvements to the Two Lions building in New Squares Penrith.
- **Creative Industries** – Work is underway to drive a range of arts and culture activities across the district to unlock the full potential of local business and communities. Initial focus includes working with the Shakespeare Globe to provide a performance of their production of Julius Caesar at Penrith and Kirkby Stephen as the basis for follow on workshops in local schools and with local businesses.

- **Connectivity** – Work is underway across all areas to consider connectivity issues as the basis for developing and driving forward a range of projects with a particular focus on improving car parking provision, cycling, walking and access to broadband. A particular focus over the last few months has been the development of a number of pilot projects to assist access to sixth form education for those young people across the district who do not have provision within their home area. The current pilots include working with Alston Federation to provide a bus service to Durham College, working with Ullswater Community College and Myerscough College to develop a travel bursary scheme for land based students and a general Eden Travel Bursary Scheme to support those young people that fall outside the first two schemes. Progress will be monitored over the coming months to inform future development of the schemes and of travel projects as part of the new Westmorland and Furness Council.
- **Circular Economy** – The roll out of the Green Eden Businesses continues with grants being offered to local businesses to assess their carbon footprints as the basis for developing and delivering actions plans.
- **A66 Dualling** – Work continues to ensure that this strategic investment benefits the local economy and communities.
- **Management** – All the governance and management structures are now in place to oversee and drive delivery (see Appendix 4 Inspiring Eden Governance Structures). Two new project managers have also been appointed to help accelerate delivery and to this end consideration is also being given to putting in place a resource to assist with project administration and monitoring.

3.2 Inspiring Eden Levelling Up Fund (LUF) Bid

- 3.2.1 Following the submission of an 8m bid based around the Inspiring Eden Enterprise Hub (IEEH) work is underway with the landowner to put in place draft heads of terms for consideration at a future Cabinet meeting. Details of the proposal have been pulled together in a Prospectus (as detailed in Appendix 2) and included on a project specific page within the Invest in Eden website. (see this link - [Inspiring Eden Enterprise Hub | Invest in Eden](#)).
- 3.2.2 The Prospectus has been shared with a range of local and strategic stakeholders to galvanise support for the project. This includes the local MP Dr Neil Hudson, who is supporting the bid and receives regular updates to help him promote the project in Government. It is envisaged that a decision will be made before the end of December.

3.3 Inspiring Eden UK Shared Prosperity Fund Investment Plan

- 3.3.1 Eden's UKSPF investment plan was submitted on 1 August and is currently with Government for decision which it is envisaged will be forthcoming by the end of December (if not sooner).
- 3.3.2 The call for projects for the current financial year took place between 16 September and 7 October. Applications have been assessed through October with a view that a final decision will be made through November; a verbal update will be provided at the Cabinet meeting. Calls for future years (including the Rural Top Up) will be launched over the coming months.

3.4 Inspiring Eden UK Shared Prosperity Fund – Rural Top Up

3.4.1 In addition to the original allocation (See Table 1 below) Eden received a Rural Top Up allocation (See Table 2 below):

Table 1 – UKSPF Allocation	
Area	Funds April 22 to March 25
Allerdale	£3,842,852
Barrow-in-Furness	£2,477,528
Carlisle	£4,104,659
Copeland	£2,638,112
Eden	£1,990,203
South Lakeland	£3,845,592
Cumbria wide	£2,326,432
Total	£21,225,378

Table 2 – UKSPF – Rural Top Up	
Area	Allocation for 2023 to 2025
Allerdale	£1,298,210
Barrow in Furness	£0
Carlisle	£474,841
Copeland	£756,584
Eden	£1,051,689
South Lakeland	£1,137,962
Cumbria	£0
Total	£4,719,286

- 3.4.2 This funding must be ring fenced for rural areas (which covers the whole of the district) and is all capital funding for investment into economic and community infrastructure. To pull down this funding an Addendum must be developed for submission to Government by 30 November. The current thinking is to focus on a grant programme and seek applications (including focusing on those projects that already form part of the Inspiring Eden Programme).
- 3.4.3 The Government guidance on the Rural Top Up sets out 11 interventions across two themes that can be used to form the basis of the Addendum to the investment plan:

Community and Place	
1.	Funding (capital grants) for investment and support for digital infrastructure for local community facilities. Corresponding with E15
2.	Funding (capital grants) for investment in capacity building and infrastructure support for local civil society and community groups. Corresponding with E11
3.	Funding (capital grants) for creation of and improvements to local rural green spaces. Corresponding with E3
4.	Funding (capital grants) for existing cultural, historic and heritage institutions that make up the local cultural heritage offer. Corresponding with E4
5.	Funding (capital grants) for local arts, cultural, heritage and creative activities. Corresponding with E6
6.	Funding (capital grants) for active travel enhancements in the local area. Corresponding with E7
7.	Funding (capital grants) for rural circular economy projects.
8.	Funding (capital grants) for impactful volunteering and social action projects to develop social and human capital in local places. Corresponding with E9
Supporting Local Businesses	
9.	Funding (capital grants) for small scale investment in micro and small enterprises in rural areas. Including capital funding for net zero infrastructure for rural businesses, and diversification of farm businesses outside of agriculture to encourage start up, expansion or scale up of these businesses where this involves converting farm buildings into other commercial or business uses
10.	Funding (capital grants) for growing the local social economy and supporting innovation. This includes: <ul style="list-style-type: none"> • community businesses • cooperatives and social enterprises • research and development sites Corresponding with E26
11.	Funding (capital grants) for the development and promotion (both trade and consumer) of the visitor economy, such as: <ul style="list-style-type: none"> • local attractions • trails • tourism products more generally Corresponding with E17

- 3.4.4 These interventions are subject to refinement through consultation with the Westmorland and Furness Local Partnership Group, a detailed review of the evidence base and discussion with Councillors via the normal reporting process and associated briefings. Once finalised the suite of interventions chosen will underpin the Addendum to the investment plan under which projects and programmes will be subsequently aligned and developed. The final Addendum will be submitted by the Council on or before the deadline of 30 November 2022. The timescale for the submission of the Addendum does not allow the Cabinet to consider the final version before the deadline, hence the need to put the appropriate delegation. It is recommended that this delegation should be to the Assistant Director Development in consultation with the Portfolio Holder for Economy and Enterprise.
- 3.4.5 The UKSPF work is being developed in partnership with Barrow Borough Council, South Lakeland District Council and Cumbria County Council to develop a common approach and enable a smooth transition as part of the local government reorganisation process. It is important to note that each district council has its own

investment plan and for South Lakeland and Eden Councils separate rural addendums will be produced. To aid this common approach all three councils are using the same consultants (Hatch) to help co-ordinate their respective plans and work streams.

- 3.4.6 Whilst Eden and South Lakeland Councils are lead authorities for UKSPF Rural Top Up Funds and will submit separate Addendums to their investment plans, the original UKSPF Prospectus makes specific reference to Local Government Reorganisation in Cumbria. It states that consent of Westmorland and Furness Council in shadow form is needed and to this end a report is being presented to the Westmorland and Furness Shadow Authority Cabinet at their meeting on the 11 November.

3.5 Penrith Borderland Inclusive Growth Deal

- 3.5.1 There has been gradual progress over the last 6 months since the Penrith Place Plan was approved as a strategy and direction of travel document. There have been a number of meetings over the last few months and the current focus is on developing specific project proposals to drive delivery; these currently include:

- **Penrith Town Hall Arts and Culture Hub** to repurpose the building as a focus for arts and culture activity in the wider Eden area.
- **Penrith Buildings and Places Improvement Scheme** with focus on empty buildings and public realm across the town centre including the Two Lions building, Unit L1 (as Inspiring Eden Town Hub), the Angel and New Squares link and New Square Empty Units as four initial projects
- **Penrith Station Gateway** with a focus on station buildings and the scope to develop a transport interchange and gateway to the town and wider area
- **National Park Discovery Centre** to promote both local National Parks (and the Pennines) and encourage dispersal of visitors across a wider area
- **Castle Park Improvements** to enhance facilities and the quality of the offer for residents and visitors
- **Dockray Public Realm Scheme** to rebalance the relationship between cars, cyclists and pedestrians

- 3.5.2 Many of these schemes will include building on the Inspiring Eden project process with a view that by 31 March 2023 a final package of projects will be agreed and for each one a project initiative document will be in place and a working group established.

4 Policy Framework

- 4.1 The Council has four corporate priorities which are:

- Sustainable;
- Healthy, safe and secure;
- Connected; and
- Creative

- 4.2 Inspiring Eden will help drive and support the delivery of all four corporate priorities. In particular, it will:

- Support key sectors including a focus on the visitor economy and knowledge based industries;
- Drive investment into key infrastructure to improve physical and digital infrastructure;
- Focus on rural areas to provide targeted support and unlock potential and optimise our natural capital;
- Generate better employment and training opportunities to improve prosperity for all;
- Drive economic recovery to enable businesses and communities to thrive;
- Champion the decarbonisation agenda with a focus on the circular economy; and
- Contribute to spatial planning and place shaping to improve local towns as vibrant community hubs.

5 Consultation

- 5.1 The Portfolio Holder for Economy and Enterprise has been consulted on this report and Cabinet have received regular updates on the Inspiring Eden Programme. All relevant external stakeholders will be consulted on the initial draft of all Inspiring Eden documents before final approval and publication.

6 Implications

6.1 Financial and Resources

- 6.1.1 Any decision to reduce or increase resources or alternatively increase income must be made within the context of the Council's stated priorities, as set out in its Council Plan 2019-2023 as agreed at Council on 7 November 2019.
- 6.1.2 Inspiring Eden will progress within current budgets and £780k investment budget agreed by Council in November 2021. Potential additional budget support from EDC for driving and accelerating delivery of the programme is included as part of the Mid Year Budget Review report being considered by Cabinet.

6.2 Legal

- 6.2.1 The provision of functions set out in this report shall be provided in accordance with relevant legal requirements including those that impact on equality and diversity and taking account of the legal duties that the Council has towards staff, residents and local businesses.

6.3 Human Resources

- 6.3.1 Inspiring Eden will provide the basis for driving service delivery with the newly restructured economic development team and contribute towards the One Eden initiative.

6.4 Environmental

- 6.4.1 Overall Inspiring Eden will have a significant positive impact on the environment as it is underpinned by an ambition to drive decarbonisation within the economy and extending sound environmental practice in the rural sector.

6.5 Statutory Considerations

Consideration:	Details of any implications and proposed measures to address:
Equality and Diversity	The Council is committed to ensuring it meets the Public Sector Equality Duty in order to provide equality of opportunity through access to services for all and delivering services which meet the needs other Council's customers. Inspiring Eden will underpin the Council's approach to supporting equality and diversity in the local community by promoting and driving economic prosperity for all.
Health, Social Environmental and Economic Impact	The Corporate Plan promotes the well-being of future generations, and the post pandemic recovery of our communities. There will be positive implications from the low carbon initiatives outlined in Inspiring Eden and benefits from on-going economic opportunities that seek to promote the growth of quality jobs as part of agenda of rebalancing the economy.
Crime and Disorder	Healthy, connected, prosperous communities will reduce the scope for crime and disorder. Inspiring Eden will promote and drive economic opportunities that seek to promote the growth of quality jobs and places which in turn should have a positive impact of crime and disorder.
Children and Safeguarding	The Council will work with other agencies to promote the well-being and safety of children and vulnerable adults. Inspiring Eden will include improving economic prosperity and outcomes for future generations which will ultimately help improve the quality of life for all including children.

6.6 Risk Management

Risk	Consequence	Controls Required
Lack of support from local and strategic partners	Inspiring Eden gains little traction and has limited impact	Engage partners in development and delivery of Inspiring Eden
Loss of focus due to local government review in Cumbria	Inspiring Eden gains little traction and has limited impact	Put in place Inspiring Eden and restructured Economic Development team to help shape and drive delivery. Ensure effective coordination of UKSPF with BBC and SLDC

7 Other Options Considered

- 7.1 The alternatives to the proposal in this report was to either do nothing (which is considered not a viable option in the current economic climate) or produce a traditional economic strategy which can take a number of years to bring forward. It

is considered that in the current economic climate that an agile and flexible approach provided by Inspiring Eden is essential to support the local economy through a period of significant change resulting from the pandemic and Brexit as well and the future changes in local government across Cumbria.

8 Reasons for the Decision/Recommendation

- 8.1 To put in place an effective economic development policy and delivery framework that will drive the implementation of the Council's Corporate Plan and One Eden initiative in supporting local businesses within the current difficult economic climate and sustaining and developing this support through the local government review process.

Tracking Information

Governance Check	Date Considered
Chief Finance Officer (or Deputy)	7 November 2022
Monitoring Officer (or Deputy)	3 November 2022
Relevant Assistant Director	14 October 2022

Background Papers:

Appendices: **Appendix 1 - Inspiring Eden Pipeline of Projects**
 Appendix 2 - Inspiring Eden Enterprise Hub Prospectus
 Appendix 3 - Inspiring Eden Governance Structure

Contact Officer: **Greg Macdonald, Interim Economic Development Manager**

Inspiring Eden Project Summary

Ref No.	Project Title	Project Lead	Project Summary
1	106 Business Partnership Bus Service	106 Partnership	Provide public transport along A6 corridor between Penrith and Kendal via Shap.
2	Redhill Business Park	Willan and Lund Holdings Ltd	Create a business park which in turn will create jobs for the development of the project and also long term jobs once the business park is constructed.
3	Ashgill Waterfall Carpark	TBC	Provide parking, toilets and amenities for the waterfall. Address safety hazards resulting from increased roadside parking by visitors to the waterfall.
4	Eden Community Tree Nursery	Eden River Trust	Establish a community tree nursery in Penrith to provide: a doorway to the world of conservation; training and health and wellbeing benefits for people of Penrith and surrounding parishes; and to increase the resilience of natural habitats within the Eden Valley.
5	Eden Youth Hub - The Hub	Inspira	Year 2 of the Hub. The Youth Hub supports Eden's inactive 16-26 year olds to overcome barriers to, and perceptions of, employment by providing an holistic employment support service for this group; a 'one stop shop' where people can go to access a range of information, advice and guidance along with a breadth of learning, training, health improvement and apprenticeship opportunities.
6	Eden Youth Hub - The Hub Kitchen	Inspira	The Hub Kitchen would provide a café in the Penrith Hub, run by the Hub and staffed by young people using the service. This would provide volunteering and training opportunities.
7	Eden Youth Hub - Wheels to Work	Inspira	Providing suitable funding for Youth Hub users for transport to work including bus pass, scooter licenses and potentially funding for HGV license training.
8	Solar, Bore hole, Double Glazing	Heather Glen County House limited	Reduce carbon footprint by using renewable energy to power the hotel. Solar panels - wind turbines - double glazing - borehole.
9	Alston Moor Golf Club Observatory	Alston Moor Golf Club	Install an observatory on par or better than any other observatory in the North of England and the only one of such a significance in Cumbria.
10	Sisters in the Wild - Training and development programme	Sisters in the Wild	Sisters in the Wild run community focused bikepacking and off-road cycling events and trips for Women, Non-binary and trans people. Our aim is to build confidence and skills through supportive and inclusive cycling events, and to increase the representation of diverse groups in the outdoors.
11	Improvement to facilities, new MUGA at Penrith RUFC	Penrith RUFC Ltd	Build additional changing rooms, removal squash courts develop MUGA
12	Penrith Gateway - Improvements to train station and links to town centre	Penrith Chamber of Trade and Commerce	Create a new gateway into Penrith, improving routes into town and establishing a performance/ event space. Benefit for all users. Creates a new interface between Historic Centre and New Squares. Creates a safe welcoming walking/ pedestrian route from a key transport hub into town and back.
13	Penrith Castle Park - Rejuvenation programme	Penrith Partnership	Redevelop Castle Park for the 21st century so it is once again a destination of choice for the local community and visitors to Penrith and the Lakes.
14	Cumbria Business Growth Hub & Business Start-Up	Cumbria Chamber of Commerce	Supporting growth and competitiveness of Cumbria businesses, helping to unleash their potential and acting as a focal point for all businesses (and potential businesses) but in particular those businesses that wish to be sustainable, increase their competitiveness, productivity and grow, driving activity, providing a focus for access to support and providing relevant support and programmes, complementing and referring into what currently exists. Project partner Lancaster University Management School (LUMs) deliver Cumbria Forum, a cross functional innovation network working with senior owners/business managers to foster peer network support.
15	Waterfoot to Pooley Bridge access improvements - new footpath	Lake District NPA	Improved access along the side of the B5320 from the A592 at Waterfoot to Pooley Bridge enabling visitors to more easily link Waterfoot Camp Site, Salmond's Plantation and the Ullswater Way to Pooley Bridge and the Steamer Pier – reducing walkers walking along the B5320.
16	George and Dragon - new visitor accommodation	George & Dragon Ltd	Additional 24% of usable space to existing development. Bedroom and utility space plus services and waste storage on ground floor

17	The Helm at Croglin - community and visitor facility	The Helm at Croglin	A community centre for locals and visitors housed in a refurbished church building with appropriate fittings and facilities. Croglin Church has been closed since 2012.
18	The Link (school and employer initiative)	Inspira	Provide a link between employers and their future workforce, between the worlds of education and work, and between young people and their future career opportunities. Young people will benefit through taking part in multiple meaningful encounters with local employers, becoming more aware of local opportunities and the skills needs of the future. Employers will benefit through showcasing opportunities, career routes and skills challenges to their potential future workforce, informing and exciting them about the local labour market and bringing to life local growth plans.
19	Penrith Leisure Centre Co-location	Cumbria Partnership One Public Estate Programme	Co-locating the NHS MSK physios with GLL in Penrith Leisure Centre will free up much needed space on the Penrith Hospital site. It will encourage those needing treatment to engage in exercise, improving their health and wellbeing and offer ongoing discounted membership of the leisure centre facilities to all those involved (staff and patients alike). It will enable the development of integrated service delivery of a range of programmes, including Escape Pain, Falls Prevention, Cardio and Pulmonary Rehab and eventually Covid Rehab as well.
20	Eamont Way footpath	Barton Parish Council	A signed walking route from Penrith Station to Pooley Bridge Steamer Pier. This grant would pay for fencing along the permitted path as it crosses a farm
21	New Square to Angel Square Crossing	Cumbria County Council	Installing a zebra crossing. The aim of the project is to improve pedestrian safety within a heavily pedestrianised street of the Town centre. The crossing will be located on Princes Street, Penrith. £40,000 contribution from EDC proposed
22	Newton Rigg Agritech Centre	FERN Global Limited	The aim of the project is to support and develop agritech innovation. The main focus of the hub would be to promote the next generation of Agritech innovation in areas such as Carbon Capture, Nutrient Neutrality and develop and commercialise innovations in Agriculture, Horticulture and Forestry through emerging technologies such as Robotics, Drones, SaaS, AI, AR, Blockchain linked to Advanced Manufacturing techniques and incorporating the engineering excellence already present in Cumbria.
23	Appleby Heritage Centre - Training provision	Newton Rigg Ltd (trading as NR Training)	Re-establish a community learning and skills centre in the modern building, capable of delivering a range of practical skills' development courses aligned to National Occupational Standards. These will prepare people for entry into the engineering, land-based engineering or manufacturing sectors and also support recreational learning. Further developments will support the offering of land-based apprenticeships.
24	Newton Rigg Digital Hub	Newton Rigg Ltd (trading as NR Training)	Develop a sustainable, affordable e-learning platform (Virtual Learning Environment, VLE) that is fit for purpose and can grow to meet organisational, community and workforce needs and provide a means through which NRL can build and develop a range of services that deepen understanding and deployment of learning technologies
25	The Cumbria Rural Business Centre (CRBC)	Newton Rigg Ltd (trading as NR Training)	Provide a specialist rural facility to lead positive developments in rural industries and communities. With a permanent base at Newton Rigg, it will seek to address the economic needs of the sector alongside supporting the health and well-being of its people.
26	Bampton Valley Community Pub (Mardale Inn)	Bampton Valley Community Pub Ltd	The aim of restoring a pub to Bampton Valley, and specifically one that is owned in perpetuity by the local Community, is to improve social cohesiveness, bring additional income & employment to the rural economy, and mitigate social isolation. As such, its benefits will extend across all age ranges and demographics.
27	The Dufton Anthology	The Dufton Anthology	The Dufton Anthology – little stories of fact and legend from the Eden Valley is a venue in the village of Dufton which has been designed to serve as an idiosyncratic 'meet and greet' facility for visitors to the area. The idea is to provide creative orientation and interpretation, along with refreshments and activities for visitors and locals through an alphabet collection of story boxes, cultural objects, written sources, photographs and maps telling the stories of 26 local people.
28	High Mill Car Park - New	Alston Moor Business Association	To protect, and to grow, local retail and visitor economies via the provision of car parking and electric vehicle charging points. To create parking capacity for future development activity.
29	Old Cyclists Barn retrofit as training and workshop space	Greystoke Craft Garden Barns – Quirky Workshops	Retrfit or old barn to provide improved insulation, access and space. A ground floor accessible second studio with wheelchair friendly toilet, (possibly even wet room?) The above could be based on a more collaborative working basis with artists, to promote new local talent as well as attracting group bookings
30	Village Centre Improvement Scheme (parking)	Barton & Pooley Bridge Parish Council	Improve the ambiance of the village centre by removing long stay car parking bays. To remedy the shortage of car parking in the village by extending the Eusemere car park.

31	Support service	Cumbria Alcohol and Drug Advisory Service - CADAS	Our aim is to create a town centre based alcohol free off licence. This would be a social enterprise initiative, whereby the operating surplus would be used to fund CADAS's core service delivery for the benefit of Eden based residents dealing with poor mental health and wellbeing, linked to unhelpful substances or behaviours such as drinking, smoking and gambling.
32	New Changing Rooms	Penrith Cricket Club	To build four new fit for purpose changing facilities for ALL our current players – boys, girls, men and women and prospective new participants that we are planning for as the club progresses. We have experienced unprecedented growth in terms of numbers of players and number of teams. In 2000 we had three senior teams and one junior team – four teams in total.
33	6 Commercial Units	KS Business Park Limited	Provide high quality work premises to help the local economy of the area of Kirkby Stephen
34	Alston Moor Market	Alston Moor Market C.I.C	Revitalise the market to be a thriving market bring residents and tourists alike from Cumbria, Northumberland and County Durham and to provide Cumbria the claim of having the highest market in England, previously this was claimed by Buxton market.
35	Review Parking Charges	Penrith Town Council	Provision of off-street parking which is free or at reduced rates than currently apply, and the development of Castle Park in Penrith.
36	Castle Park Improvements	Penrith Town Council	Enhance the play area, obstacle golf and car parking at the Castle Park in line with the projects set out in the Vision Plan
37	Changing Places Facilities to assist disabled access across a range of attractions	Eden Tourism Network	Provision of Changing Places (CP) facilities at various locations throughout Eden. Project will benefit visitors, day trippers, residents and other visitor economy and associated businesses. Funding bid has been made to Dept for Levelling Up. Matched funding of £30k required if CPT grant awarded.
38	Alston Women's Institute - equipment for events	Alston Womens Institute	Improve the range of speakers by providing Zoom functionality and equipment (screen, microphone etc). £1,0704.70 awarded
39	Holme Holt Riverside Car Park - new	Ainstable Parish Council	Build a riverside car park and to provide access to the river bank and the associated footpaths for all. At present the only parking is on the bridge which is not wide enough to support parking. This results in the bridge becoming cut down to a single lane with delays and problems crossing the river.
40	Provision of Kirkby Stephen Youth Centre	Evergreen Community Trust	AIM To open a new YOUTH CENTRE in Kirkby Stephen in 2022. BENEFICIARIES Young People and Families resident in the Upper Eden Area will benefit from the provision of newly established Youth Centre and Youth Group where there is no current provision in Kirkby Stephen. Potential UKSPF funding.
41	Jubilee Park - Redsign Entrance	Jubilee Park Charity	Secure the redesign and refurbishment of the perimeter and entrance of Jubilee Park together with the amenity land/hardstanding at the entrance just off the A685 at the southern gateway to the Town creating a welcoming and positive aspect to both Town and Park.
42	Alston Emporium and Once Upon A Time Bookshop	Alston Emporium and Once Upon A Time Bookshop	Provide a community garden and use of the building for community use. Provide a valuable resource for adult and child literacy via book readings and other educational use of the bookshop. Provide a quiet space with wifi access for students to study. Provide accessible access to the bookshop via a stair lift.
43	Purposeful Business Start-up Programme	Future Fixers CIC	Business Start-up support programme for purposeful businesses. Participants in the programme will be in a position to start, or grow, a purposeful business; a business with people and planet at its heart. They will also have learnt how to stay resilient during the ups and downs of their journey.
44	Climate and Carbon Literacy	Cumbria Action for Sustainability	CAFS submitted a number of Expressions of Interest for different initiatives. They have been asked to submit one application form with a proposal for a first year programme.
45	Cold to Cosy Homes	Cumbria Action for Sustainability	<p>we will deliver in-home energy advice and energy saving measures to residents of Eden district to help them keep their homes warmer and reduce their energy use.</p> <p>This will help the residents to:-</p> <ul style="list-style-type: none"> ☑ Afford to keep their heating on for longer. ☑ Reduce physical and mental health related issues with people living in cold, damp homes. ☑ Reduce people struggling with fuel poverty <p>By reducing their spend on energy they will reduce the chance of falling into fuel poverty and associated debt</p> <ul style="list-style-type: none"> ☑ Reduce wasted energy <p>This will support Eden reducing their carbon footprint</p>
46	Core Support	Cumbria Action for Sustainability	See Ref 44

47	Zero Carbon Leadership	Cumbria Action for Sustainability	See Ref 44
48	Cumbria Green Businesses Network	Cumbria Action for Sustainability	See Ref 44
49	Greener Schools	Cumbria Action for Sustainability	See Ref 44
50	Growing Eden	Cumbria Action for Sustainability	See Ref 44
51	Solar Made Easy	Cumbria Action for Sustainability	See Ref 44
52	Accessible Appleby	Debbie North/ Access the Dales	Undertake an accessible audit of the town At the end of the project there will be a comprehensive document about the venues, hotels, guesthouses etc that at wheelchair accessible. This document can then be kept at tourism information offices or online or in leaflet form for information for visitors to Appleby.
53	Inspiring Eden Farmers Support and Advisory Service	The Farmers Network	Provide information to help farmers make informed decisions for their businesses at a time of unprecedented change in the industry through workshops and one to one advice designed to complement activity funded by other programmes. Help farmers measure their Greenhouse Gas emissions through carbon auditing and testing their soils to measure the amount of carbon stored. Provide training and development opportunities for younger farmers through funding for our training voucher scheme and training bursaries. Work with Eden District Council to connect farmers with other rural initiatives and services funded by the Local Authority.
54	Improved community facility	All Saints Church, Renwick	Building improvements to the Church. The end result will be a watertight building much more suitable for wider community and tourist use.
55	Concrete Road – Access Improvements	Lake District National Park Authority	The Concrete Road is an existing 5 mile private road (originally an access track for United Utilities between the A6 and Haweswater Reservoir at Burnbanks) which also has permitted access for walkers, horses and cyclists. The route does have a number of potholes and rough sections which limits the usage of the route. Improved permitted access route for cyclists, walkers and horseriders enabling a wider audience to enjoy the route.
56	Haweswater West Shore Cycle Way	Lake District National Park Authority	The aim of the project would be to improve and upgrade the existing 9 km of Public Footpath to Bridleway status, enabling cyclists to cycle along the side of the lake shore. This would then enable cyclists to cycle around the entirety of the reservoir – both along the western shore off road, and then along the quiet road on the eastern side.
57	High Mill Visitor Centre	Alston Moor Partnership	A large derelict building overlooking Alston Town centre will be restored, creating a more attractive environment for local residents and visitors. A visitor attraction will be created increasing town centre footfall and visitor spend, thus benefitting local traders and improving viability of town centre shops, cafes, etc.
58	Demonstrating Farming to “Net Zero” in Eden	The Farmers Network	The aim of the project is to increase farmers’ understanding of their carbon emissions, how these might be reduced, the effect on their farm business and the farm environment and how they might increase the carbon stored on their farms in their journey to “Net Zero”. The project also aims to communicate to the wider Eden community the role of farmers in achieving “net zero” and mitigating climate change.
59	Penrith Playhouse Cultural Hub	Penrith Players	New facilities at Penrith Playhouse including retractable seating, bar/café improved sound and ventilation to create a community space which can be used as a cultural hub
60	Rheged Sustainable Development	Westmorland Family Ltd	To create a sustainable hub for Westmorland on neighbouring land, supporting local jobs and businesses enhancing the offer of the adjoining Rheged Centre; providing production and storage facilities for artisan products sold out of existing Westmorland businesses and will support Westmorland progress towards being environmental sustainability.

61	In to Eden	Cumbria Youth Alliance	To introduce, develop, further extend reach in to Eden, embed and sustain programmes. To introduce new programmes starting in Eden ensuring collaboration, working with partners to achieve the very best service for young people in Eden aged 14yrs – 24yrs to enable them to reach their full potential.
62	Visiting Eden's Church Heritage	Churches Trust for Cumbria	Provide church communities with professional advice and guidance to develop their tourism potential. Church buildings/communities would benefit from marketing and promotional advice in interpreting and raising the profile of these historic sites and their potential visitor offer.
63	Eden in Focus	Sarah Hewitt Photography	The project will provide a small selection of local struggling businesses with some high-quality marketing content for use on their social media/website. The project will then help the businesses make best use of their marketing going forwards. An exhibition of the images at the end of the project will help shine a spotlight on the businesses and the excellent work taking place in the Eden district. Sarah Hewitt Photography is a socially driven photographic practice. Sarah Hewitt Photography will act as the photographer and end to end project manager for the entire project.
64	Glenridding Pier House Phase 2 Extension	Ullswater Steamers	Glenridding Pier Phase 2 will result in increased capacity for visitors in the ticket/retail/catering and create a visitor hub for domestic and international visitors. Increase engagement with visitors and promote local, sustainable travel to 'keep it local'. Creates a positive feedback loop in the local supply chain, increasing spend and contributing to the local economy.
65	Improving Guest Accessibility	Meadow View B & B	Adding shower and stair lift to guest accommodation.
66	Visitor App	St Cuthbert's Church, Great Salkeld	Tourist Information App - give tourists/visitors and opportunity to get to know more about the church, one of the oldest churches in Cumbria with the best example of a peel tower and to put this into context within the parish of Great Salkeld and the surrounding area
67	Attract & Disperse Eden	Cumbria Tourism	To build on the strong momentum from Cumbria Tourism's recent 'Attract and Disperse' destination marketing campaign, focusing specifically on: <ul style="list-style-type: none"> • increasing awareness of the Eden area as a place to visit • extending overnight stays • increasing out of season visits • increasing economic value to businesses during the quieter winter months Accommodation, shops, restaurants and petrol stations will all directly benefit from this campaign as it will help them to stay open during the quieter months.
68	The Innovation Catalyst – Creating Prosperity in Place	Lancaster University	The Innovation Catalyst will target a range of organisations to create a thriving place-based innovation ecosystem, bringing together the key stakeholders within Eden - businesses (large and small), entrepreneurs, the public sector, finance, the university and other relevant stakeholders. It will embed local authority participation, work closely with relevant local clusters and the LEP to identify challenges and apply/develop technologies and services that are pertinent to the 'place' and emerging business clusters ensuring collective solutions with stakeholder buy-in. We believe that the COVID pandemic, new modes of flexible and digital working and the re-balancing of urban/rural living that has been driven, provide a new opportunity to develop a connected innovation ecosystem that was previously thought only possible in large urban areas. This proposal builds on our aspiration to work with regional partners to develop an M6 Innovation Corridor and will enhance an existing portfolio of programmes across the NW where learning, clusters and eco-systems will be shared.
69	Eden Community of Leadership Learning	Centre for Leadership Performance	Centre for Leadership Performance submitted a number of Expressions of Interest and were asked to complete 1 application form for year 1 project across Eden. Increase leadership skills and capability, both now and in the future. We plan to do this by creating a leadership learning community, made up of Eden based employers, employees, educators, community groups and young people; to exchange leadership learning and resources, harness everyday leadership opportunities and develop a sustainable learning network.
70	Learn to Lead (LL-EOI)	Centre for Leadership Performance	See Ref 69
71	Cumbria Future Leaders (CFL-EOI)	Centre for Leadership Performance	See Ref 69
72	Leadership Toolbox (LT-EOI)	Centre for Leadership Performance	See Ref 69
73	Leader 2 Leader (L2L-EOI)	Centre for Leadership Performance	See Ref 69

74	Sense of Purpose (SOP-EOI)	Centre for Leadership Performance	See Ref 69
75	Dream Placement (DP-EOI)	Centre for Leadership Performance	See Ref 69
76	Leading Change (LC-EOI)	Centre for Leadership Performance	See Ref 69
77	ProjX (PX-EOI)	Centre for Leadership Performance	See Ref 69
78	SkillsBlox (SB-EOI)	Centre for Leadership Performance	See Ref 69
79	Bright Futures (BF-EOI)	Centre for Leadership Performance	See Ref 69
80	Ullswater Steamers - All weather, maintenance and engineering shed	Ullswater Steamers	Build undercover workshop to protect winter maintenance schedules
81	Inspiring Eden Rural Enterprise Hub	Eden District Council	Design and build an enterprise centre to support local enterprise and entrepreneurship, This will include providing easy in out terms, a focus for business support services and design that nurtures and encourages collaboration.
82	Penrith Town Hall Arts and Culture Centre	Eden District Council	Development of Town Hall into an Arts and Culture Centre
83	National Park Discovery Centre	Eden District Council	Nation Park Discovery Centre in Penrith (New Sqaures unit)
84	Inspiring Eden Business Support Programme	Eden District Council	Continue to provide business support services through partners.
85	Penrith Castle Park	Eden District Council	Developments to Castle Park
86	Inspiring Eden Cultural and Heritage Action Zone - improvements to building and public spaces IE Hub and Two Lions	Eden District Council	Set up IE hub in New Squares and develop Two Lions building
87	Better Homes Eden - Handyperson Service	Better Home Eden	improve the housing conditions for all residents across Eden prevent accidents in the home (i.e. falls) and thus reduce the number of hospital admissions speed up hospital discharges by quickly installing measures for patients to return home i.e. grabrails The end results will be safer and more secure homes, giving residents peace of mind and security, preventing hospital admission and speeding up hospital discharge.
88	St Andrew's Church Tercentenary Development Project - arts and culture facility	St Andrews Church	By imaginative landscaping of the grounds and refurbishment of the church this project will revitalise Penrith Town Centre as a venue for tourism, cultural, social, educational and community space. The grant support will be spent in further work to develop this project and to ensure a successful conclusion with the engagement of a professional Project Manager and Architects for the Initial Concept Design.
89	Facilities to support activity in Alston recreation ground	Alston Recreation Ground	Stalls and attractions to encourage more visitors to Alston Producers Market. Funding needed for more gazebos, tables etc. A small tractor and trailer to carry theses to and from the storage unit, which is over the other side of the 5 acre site. £4,940.36 awarded
90	Food2Fuel scheme to genral energy for waste food	Evolve Penrith	the Eden Food2Fuel will use food waste collected from the Eden area to enable the delivery of a circular supply chain in two separate processes. 1 - a portion of food waste used as a food source for maggots that will in turn become a live meal for chicken producers to use to feed hens. 2 - using the bulk of the food waste will be used to feed a new purpose built a anaerobic digestion (AD) to create energy from food which would otherwise go to waste.
91	Develop High Mill annexe building living /workshop space	Trevor Cooke	Utilise a currently derelict commercial building, to provide cheap housing, workspaces and a possible solution to the parking problem that Alston currently experiences from visitors. We aim to offer an environmentally friendly personal transport solution that will not only increase visitors to Alston, but also to outlying villages, such as Garrigill, Nenthead, Slaggyford and Ashgill Force.

92	KS Town Forum & market rejuvenation	Kirkby Stephen TC	To set up a Kirkby Stephen Town Forum/Chamber of Trade to assist businesses in working together to keep the High Street current and prosperous. To set up a website to help rejuvenate the market in town.
93	ALATI - local exhibitions of arts and culture for visitors and locals alike	AlstonLandscape Art Town Initiative	ALATI is a regeneration through culture initiative to bring more tourists to the area for talks, classes, guided walks and exhibitions about landscape art. It is also intended to enhance the lives of local people by running art competitions for local schoolchildren and open exhibitions for local artists.
94	Ryder Fit Gym	RyderFit	Set up a gym in Morland for use by local community
95	Cloisters and East Tower	Appleby-in-Westmorland Town Council	Essential building repair works to the Cloisters building and East Tower.
96	The Key	Inspira	The key will provide high-impact employability support to help people get into work, quickly. The project will benefit both jobseekers and local employers. It will connect businesses that have immediate, hard-to-fill vacancies with local people who are unemployed or inactive in the labour market. By providing essential industry skills and training, insights into workplace requirements and expert practical coaching for applications and interviews, the project will give participants focused, practical support to boost their employability and help them move immediately into real jobs.
97	TBC – Workforce Skills Development	Carlisle College	In response to the LSIP and to replace existing Edge Project, the project will help to bridge the skills gaps seen by employers across Eden. The intention is for a project that will be far more flexible than the previous Edge and will allow for greater delivery of targeted skills that may not be regulated (not qualification driven) and will allow for delivery of license to practice certificates required by employers.
98	Active Cumbria Sport – Improving Assets & Increasing Participation	Cumbria County Council	Through the capital element of the fund, provide financial support to clubs and other sports organisations to improve the infrastructure of sports facilities, making them more accessible and relevant to existing and new members, thereby attracting increased community use, and improving their resilience and sustainability for the future. Through the revenue element of the fund, provide financial support to organisations to increase the number of sporting tournaments, events and festivals taking place, thereby increasing engagement in sport and actively increasing participation levels across the area.
99	Cost of Living Advice (CoLA)	CACE	Offering Cost of Living Advice to Eden residents. It will support those that have been impacted by the pandemic which may have resulted in lost or reduced income. It will help those who are struggling to manage rising costs including childcare, fuel, energy, food and housing. At a time when inflation is higher than wage and benefit increases we need to ensure access to our services for those most affected and most in need. Recent experience indicates that our clients prefer to access services remotely in the first instance so we will provide advice via telephone, email and webchat delivery channels, with face-to-face follow-on appointments as required. Our advice and information will be promoted over a range of channels including social media and our websites as early intervention support for those beginning to experience problems.
100	Public space CCTV Replacement Project	Cumbria Constabulary	The aim of the Project is to replace the existing infrastructure with the latest technology which will ensure the continued running of the CCTV solution and enable the Constabulary to maximise the latest software to protect the members of the public. There are four core elements to the solution – <ul style="list-style-type: none"> • Cameras & Connectivity • Poles • CCTV software • Technical Infrastructure (Servers/Storage)
101	STAR (Sport, Tech, Active Resilience) Project	People First Independent Advocacy (PF)	The Sport, Tech, Active Resilience (STAR) project will resource and tackle some fundamental wellbeing and health inequality issues for adults with learning disabilities &/or autism, in a real, sustainable way. It devises a health and wellbeing programme for this target group in Cumbria, intrinsically embedding the training in, and use of technology, to expand an ever-increasing reach and positive impact on these vulnerable individuals. Importantly it will have a fundamental impact on participants' support networks, services and the communities they live in. STAR is a health and wellbeing project for adults with learning difficulties &/or autism.

102	Cumbria Night Safety Charter	Office of the Police and Crime Commissioner for Cumbria	Fund a Project Officer to introduce and deliver the Cumbria Night Safety Charter to businesses across Cumbria that operate at night. The Cumbria Night Safety Charter has been developed by the OPCC and is ready to be rolled out across the county. The fund will pay for a Project Officer to coordinate the delivery across Cumbria, to work collectively with public authorities, partners and private businesses to ensure that safety is prioritised, training is delivered, any issues are responded to to encourage a thriving night-time environment.
103	School Transport Programme (Alston Moor, Newton Rigg, UCC/Myerscough?)	EDC	Provide post 16 transport. It can be very difficult for young people and their families to access education after they leave school in rural Eden at the age of 16. Public transport is patchy, and private arrangements can be very costly and inconvenient for families. A grant scheme is being developed. Current focus in on Alston Federation Bus to Durham Collage, UCC/Myerscough Land Based Bursary and general Eden Bursary for residents
104	Get Cumbria Buzzing (Eden)	Cumbria Wildlife Trust	Identify the green spaces that matter most to communities and have the greatest potential for improvement. We intend to work intensively with 10 identified communities over the two year project, with a further 50 communities taking part in The Big Plant for Eden.
105	Green and Clean	Penrith Industrial BID	Support businesses to become more carbon neutral and energy efficient. It is hoped to engage with all 153 businesses across the three estates. The main benefit will be the reduce carbon footprint and reduce energy usage and costs within each business. The plan is to begin with a full energy survey of the businesses within Penrith Business Parks to determine the energy usage of each business and the potential opportunities to replace with renewable energy sources. Phase 2 would be to work with businesses to offer either matched funding or support funding to incentivise businesses to act on the survey recommendations.
106	Developing Net Zero Community Projects	Lancashire County Council	Establishment a community energy group to facilitate communities taking charge of their own energy generation, working alongside the local authority – making energy affordable and clean. The project builds upon the experience of the NW Rural Community Energy Fund, using the lessons learned including expanding coverage to urban areas. This can be done by investing and owning in renewable energy assets, heat networks or EV car clubs.
107	Zero Carbon Cumbria Partnership Development - Community Engagement	Cumbria Action for Sustainability	The project would directly deliver on the intention of intervention E12: Investment in community engagement schemes to support community involvement in decision making in local regeneration. Meaningful and genuine engagement and consultation with local residents builds trust, creates strong relationships that foster a sense of place, pride and a feeling of belonging in a local area. This can help set the foundations for economic recovery and development at neighbourhood level.
108	Zero Carbon Cumbria Partnership Development	Cumbria Action for Sustainability	We have a unique opportunity to make Cumbria the first county to achieve net zero. Zero Carbon Cumbria Partnership (ZCCP) is a well established and widely supported network of around 80 Cumbrian organisations including third, private sector and public sector representatives with a shared objective of achieving net zero carbon as soon as possible. Investment from the SPF would enable ZCCP to increase the team's capacity
109	Minibus transport to Newton Rigg SEE EO1103 for all School transport	Newton Rigg Ltd (trading as NR Training)	Newton Rigg post 16 transport Now amalgamated into EO1103
110	Upskilling the Cumbrian Workforce	University of Cumbria	sizes to boost productivity with resultant impact on pay, jobs and associated living standards. This would in turn result in business growth with more competitive and new products, processes and services. We would work together to support authorities to build pride of place and improved life chances by supporting local businesses and communities with specialist local provision to develop and grow, in order to: <ul style="list-style-type: none"> • safeguard and create jobs and cohesion, improve pay and productivity by building on key and emerging industries, capabilities and local strengths • encourage collaboration across sectors by facilitating and encouraging businesses to invest in their staff by enabling them to access courses and programmes where they will share knowledge and gain new skills
111	Naddle Farm Development Project	RSPB	The end result of the project will see: <ol style="list-style-type: none"> 1) a former spinning barn, with local historic and cultural importance, sensitively restored into a community resource 2) conversion of a former kennel block into a bunkhouse offering welcoming lodgings for walkers (especially those on the Coast-to-Coast trail), groups seeking outdoor activities sensitive to the natural environment, visiting staff, volunteers, scientists: an example of farm-based accommodation/diversification

112	Penrith Railway Station building enhancements	EDC/ Network Rail/Avanti	Providing empty let shell buildings for development opportunities from works on the Station masters house (front of station) and 2 buildings on island platform. The aim is to attract a café/pub/restaurant facility, cycle hire and an element of community space.
113	A new operational base for Penrith MRT	Penrith Mountain Rescue Team	Create a new, larger operational base for PMRT, which will meet our requirements both now and into the foreseeable future. Beneficiaries might include any resident of Cumbria or any visitor needing urgent assistance in the fells, rural and urban areas.
114	Ernest's Army	The Ernest Cook Trust	Help 18 young people aged 16 – 24 move into employment.
115	Bridge Street Garage	Bridge St Garage	To secure the structure of the building and improve the building as an Appleby shop front façade.
116	Business & Community Innovation Programme	University of Cumbria	The Business & Community Innovation Programme brings together inter-related and complimentary areas of innovation support to enable businesses and organisations to progress along their innovation journey. This transformational programme will jointly harness the existing knowledge, expertise and facilities of three Universities, for the benefit of businesses and communities.
117	Dental Practice expansion to creat 2 new dental surgeries	Ghyllmount Dental Practice	The addition of 2 new dental surgeries, added to the 5 surgery site at Ghyllmount Dental would transform the clinic into a 7 surgery practice. We want Ghyllmount to be a centre of excellence for dental care and education in Cumbria. The 2 new surgeries would enable us to drastically reduce the waiting times and enable us to start accepting new patients.
118	Insight Centre	Enable Success Ltd	A locally based hub with the ability to tap into global expertise in supplying Analytics as a Service for the local businesses. Essentially as digital transformation will continue to grow (Data is often described as the new 'oil' – less toxic though!) and information becomes 100% data driven
119	Pizza Roma	Pizza Roma	Weather proof and make safe the building from severe flooding and also protect the historic bridge that the building attaches on to
120	Changing Places Facilities to assist disabled access across a range of attractions.	Acorn Bank	Support towards new Changing Places Toilet. Supported through Welcome Back to Eden £3,360 awarded
121	Penrith May Day Carnival 2023	Penrith Lions	Support for the Penrith May Day Carnival 2023. Possible Welcome Back 2 Eden fund.
n/a	James Farmer, Temple Sowerby CC		Cricket club funding to improve its facilities for the local community.
122	ED project for School travel UCC/Myerscough. SEE EOI103	EDC/ Network Rail/Avanti	REPLACED BY EOI103
123	Feasibility study to identify options for development of land at back of The Old Courthouse, Shap	The Old Courthouse CIC	Commission feasibility study to identify options for development of land at back of The Old Courthouse, Shap
124	Enhance marketing of The Old Courthouse	The Old Courthouse CIC	Enhance marketing of The Old Courthouse to the community and potential user / visitor markets
125	Cold Springs	Cumbria Wildlife Trust	Develop the land at Cold Springs for both wildlife and people by undertaking extensive habitat restoration and providing access and interpretation for local people and visitors.

Inspiring Eden

ENTERPRISE HUB

ACHIEVING RURAL EXCELLENCE

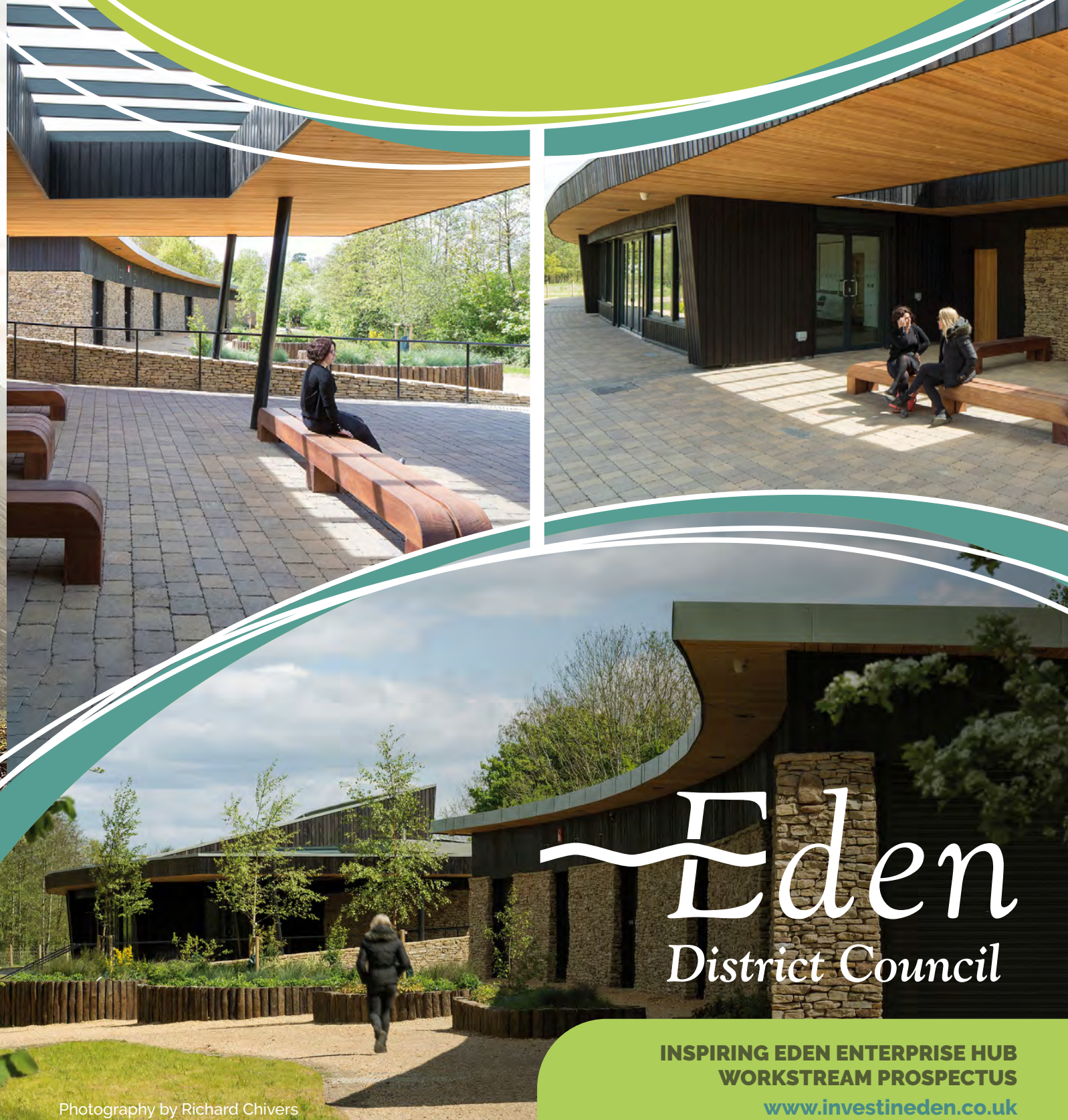

Eden
District Council

INSPIRING EDEN ENTERPRISE HUB
WORKSTREAM PROSPECTUS
www.investineden.co.uk

LOCAL AND STRATEGIC IMPACT...

Supporting Eden - The Hub will provide a base to support the development and delivery of satellite enterprise facilities across all our communities with a particular focus on Appleby, Kirkby Stephen, and Alston. This will ensure enterprise and entrepreneurship is placed at the heart of local economies and community life and, as a result, be an exemplar of rural working and living in the 21st Century.

Supporting Penrith - The Hub is already helping with the development and delivery of other key initiatives, including its sister project, the Inspiring Eden (town) Hub (at the heart of Penrith town centre). This will provide the base and shop front for the Inspiring Eden Project team and a platform from which to drive key projects such as improvements to the Two Lions building, several public realm schemes and addressing the key issue of empty shops. It is from this Town Centre hub that the project team will focus on the development and delivery of other key projects, such as the Penrith Town Hall Arts and Culture Hub, the Penrith Station Transport Interchange, the Castle Park Rejuvenation Scheme, and the National Park Discovery Centre.

Supporting National Priorities - The Hub will play a strategic role, while working with local universities, in shaping the delivery of the M6 Cyber and Digital Corridor, which will support national ambitions around these sectors and the wider knowledge economy, land-based sector and creative industries all of which will help improve wages and prosperity across the area.

THE TIMEFRAMES...

ACTIVITY	2022												2023												2024																								
	J	F	M	A	M	J	J	A	S	O	N	D	J	F	M	A	M	J	J	A	S	O	N	D	J	F	M	A	M	J	J	A	S	O	N	D													
Development of concept and submission of Levelling Up Fund bid for submission by 6 July 2022 deadline																																																	
Confirmation of the position of the land with landowner and development of mobilisation timetable																																																	
Appointment of Project Manager/ Quantity Surveyor consultants to act as Eden District Council's agents																																																	
Appointment of delivery team (Architect, Structural and Civil Engineer & Principal Designer)																																																	
Securing detailed planning permission																																																	
Procure main contractor																																																	
Procure operator																																																	
Construction																																																	
Open																																																	

PROJECT OVERVIEW

Design and development of a new £8 million facility for rural enterprise creation, development, and growth in Eden as a key component of the district's 'Inspiring Eden' initiative to drive economic recovery, prosperity and levelling up.

It will provide 3,390 sqm of new high quality managed business space in Eden and a focus for business support services outreach, supporting an estimated 740 businesses both within the Hub and in the wider district, creating an estimated 655 jobs and £26.2m in additional economic value over a 10-year period in existing and diversified growth sectors.



For more information about Inspiring Eden,
Email: econ.dev@eden.gov.uk
Telephone: 01768 817817
Web: www.eden.gov.uk
Business focused advice: www.investineden.co.uk
Visitor destination site: www.visiteden.co.uk

THE CHALLENGE...

Low Productivity – Gross Value Added per filled job (£47,100) is marginally higher than Cumbria but only 83.1% of the UK, and very low for tourism and agriculture sectors (respectively £24,300 and £23,900).

Declining working-age population – by 5.2% in the past 10 years (compared with a UK increase of 2.9%) and a projected 9.1% fall between 2022-42 (greater than -8.6% for Cumbria and a continued contrast with the UK of +1.4%).

A significantly ageing population – a projected -10.7% fall in those aged 0-15 for 2022-42 (compared with -8.6% in Cumbria and -3.5% in the UK) but a 32.6% increase in those aged 65+ (23.6% in Cumbria). The significant expected fall in young adults aged 18-24 (-4.9%) for reasons including a lack of job opportunities and in particular house prices.

A thinner pool of higher-level skills and an excess of low-skilled workers – in 2021, 33.8% of Eden working-age residents were educated to degree level compared with 43.1% in England, while 7.8% had no qualifications compared with 6.4% in both Cumbria and England.

A business start-up rate across Cumbria less than two-thirds of the England average – business births in Eden in 2020 were 6% of stock compared with 13% in England, although its 5-year survival rate (54%) is reflected in lower business deaths (5%) compared to 12% in England.

COVID19 impacts – 23% of workers were furloughed in the peak of Jan/Feb 2021 (compared with 19% in Cumbria and 16% in England during the same period), and a dramatic increase in high-risk credit score businesses in 2021 (25.5% annual change in Eden compared with 15.2% in Cumbria and 8.1% in the UK).

Sectoral dependence and few fast-growing firms – heavy dependence on agriculture and tourism with a greater number of slower-growing businesses, and a limited knowledge economy with relatively small professional (1,500 workers) and other services. It has a significant proportion of workers in elementary occupations (13.6% compared to 10.7% in Cumbria and 9.4% in the UK).

Deprivation – while less deprived, nevertheless it suffers from pockets of deprivation in particular areas. South Penrith (Lower Super 'Output Area' within the most deprived 30% in England) and has the highest proportion (52.8%) of Lower Super Output Area in the most deprived 10% nationally for 'Geographical Barriers' and the 'Indoors' Sub-domain (63.9%).



THE OPPORTUNITY...

The Enterprise Hub will be a modern high quality business space (up to 90 business units and collaboration spaces) that will:

- Provide modern, flexible, and affordable premises for small to medium sized enterprises (SMEs) supporting existing key sectors and new growth sectors (including knowledge-based industries) with 'easy in, easy out' terms.
- Promote business growth by providing a base for training, support, and advice for businesses across the area.
- Boost entrepreneurial activity within the rural economy and among key under-represented groups (including women) and increase business formation rates.
- Improve the competitiveness of local SMEs by increasing their capacity and capability, value added, and employment creation.

- Create a focus for links with the Further & Higher Education sector and other organisations and foster an ecosystem of business collaboration and knowledge transfer.
- Provide a 'landing pad' for inward investment.
- Ensure a viable and sustainable long-term operating model.
- Provide the basis for capitalising on Eden's well developed social enterprise activity and status of being home to Alston - the world's first Social Enterprise Town.

PERFECTLY PLACED...

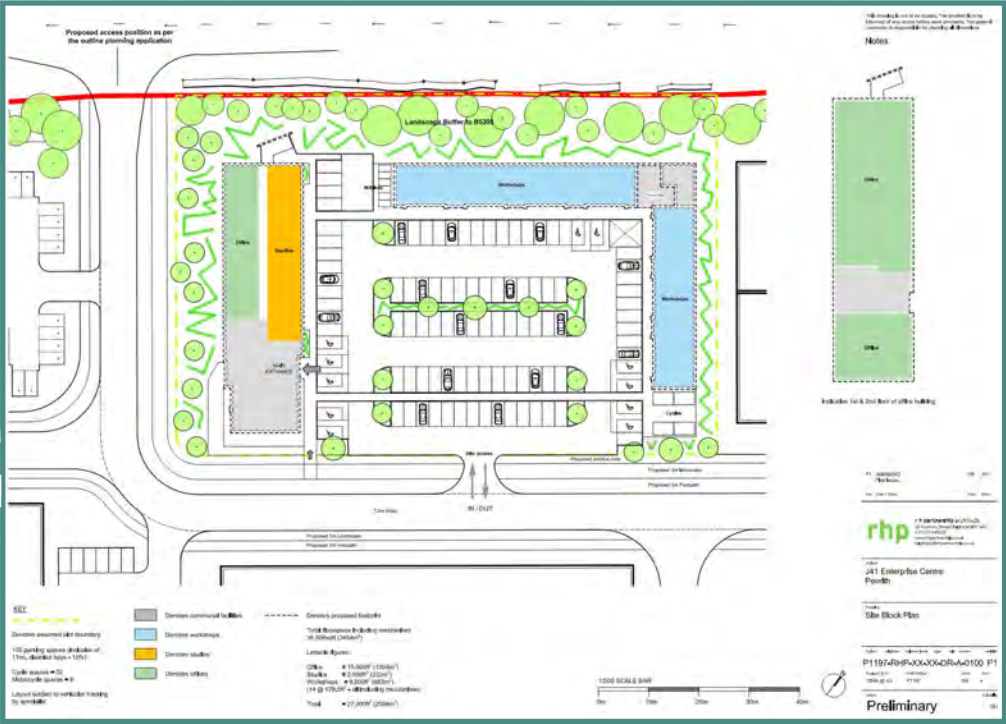

COLLABORATION IS KEY...

Delivered by Eden District Council in conjunction with the site owner. The project involves several local and strategic stakeholders who have provided support; below are testimonials from key individuals and organisations:



1. Cllr Virginia Taylor and Cllr Mary Robinson - Eden District Council: "The Enterprise Hub is the flagship project for Inspiring Eden, the Council's plan for economic recovery, prosperity, and levelling up - achieving rural excellence for our communities and businesses. It will play a crucial role in placing enterprise and entrepreneurship at the heart of our communities. This ambitious project - and the wider Inspiring Eden initiative - demonstrates the council's commitment that communities thrive and that businesses grow and prosper. It is important when seeking Government investment that we bear in mind not only what Government can do for us but also what we can do to support UK plc on a global stage."

2. Dr Neil Hudson - MP: "I see the 'Inspiring Eden' Enterprise Hub as a vital stepping-stone in the Government's ambition for levelling-up across the whole of rural Eden. Countless numbers of people, young and old, will benefit from this grant for generations to come, boosting our resilience and also helping enhance the physical and mental wellbeing of our communities."

3. Paul Foster - Development Manager (Lancashire & Cumbria) Federation of Small Businesses: "It is the kind of facility rarely seen in rural areas and will have multiple benefits to existing and prospective entrepreneurs"

4. Jo Lappin MBE - Chief Executive Cumbria Local Enterprise Partnership: "There is a clear need for additional business space in Eden, which the Enterprise Hub will help to address. Importantly, it will offer easy access terms to businesses and has been designed to meet a range of requirements from start up to grow on space across all of the sectors operating within the economy."

5. Professor Brian J Webster-Henderson: - Deputy Vice Chancellor (Health, Environment & Innovation) University of Cumbria: "We would hope that in addition to benefitting Eden's economy, that this facility will be utilised by some of the University of Cumbria's many entrepreneurial students and alumni thereby assisting with graduate retention in the county. There is further potential for businesses to benefit from local research & innovation expertise and to input into higher education agendas and priorities."

6. Suzanne Caldwell - Managing Director Cumbria Chamber of Commerce: "Cumbria Chamber of Commerce is keen to support the Inspiring Eden Enterprise Hub, which we feel will play a vital role in driving the growth and success of Eden's economy."

7. Jim Walker - Chair Eden Tourism Network: "Our members are by definition mainly small operators and this type of support for them and also new tourism businesses setting out, all within a modern facility, could make a real difference."

8. Linda Farrar - Chair Alston Fairhill Committee | Alston Recreation Ground: "We realise what an important asset this will be for the promotion of rural enterprise in Eden."

9. Rob Randell - Chair, Cumbria Social Enterprise Partnership: "The proposal meets with many of the aspirations we have in developing the World's First Social Enterprise Zone."

10. Ian Grey - Alston Moor Business Association: "There is a clear need for high quality business support space in the area for both existing and new businesses. In addition, we recognise that this project would help businesses in Eden realise their potential and attract significant levels of inward investment which will inevitably benefit the economy across Eden."

11. Dion Williams - Director of Research, Enterprise & Innovation / Associate Dean for Enterprise & Engagement Lancaster University: "This fully aligns with Lancaster University's strategic drive to work with our regional partners such as Eden District Council and local businesses to ensure that our region levels out as well as levels up, and that the potential for our more rural areas is realised and we achieve cross regional prosperity beyond, but complementary to, our major city regions."

12. Michael Bell - Bells of Lazonby: "The Enterprise Hub will help incubate and support fledgling businesses that will be the reliable backbone of the local economy for decades to come."

13. Cllr Phil Dew - Chair of Eden Area Committee: "The proposal for the enterprise hub has a good strategic fit with local economic development strategies and the business support ecosystem."

Appendix 3 - Inspiring Eden Governance Structure

